

Box contents

- 1 Speaker
- 2 Grilles
- 4 Mounting screws
- 2 Wire nuts

NOTE: the CI-MM3-II is designed to install into a standard 2-gang junction box. Phase Technology recommends you test the fit before installing the junction box.

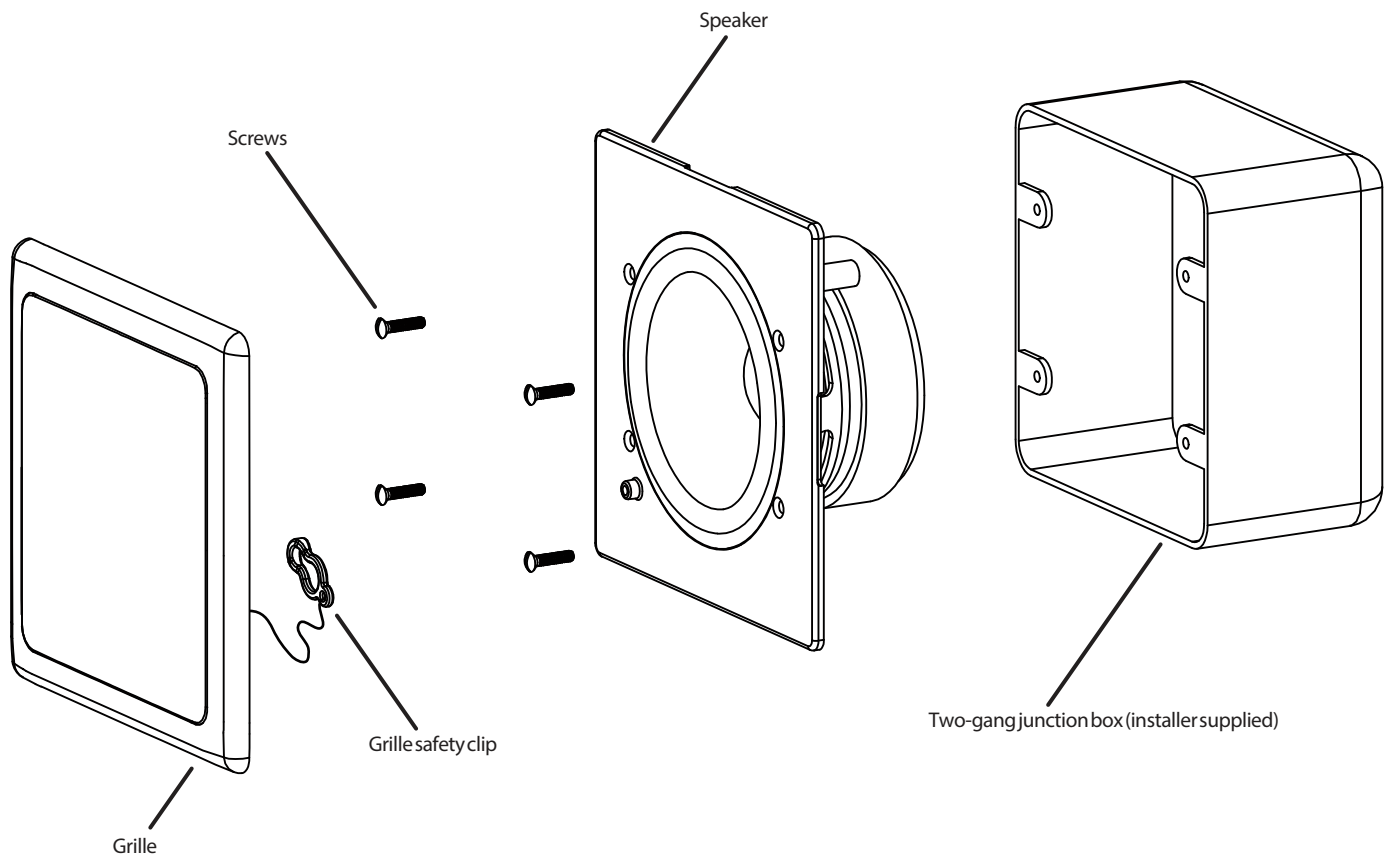

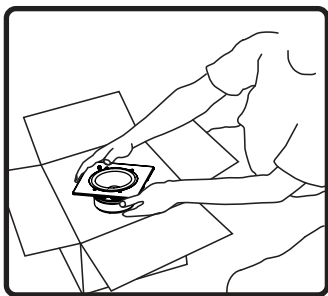

1. Unpack speaker.

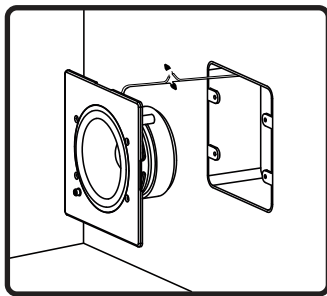

2. Connect speaker wires to signal wires using included wire nuts.

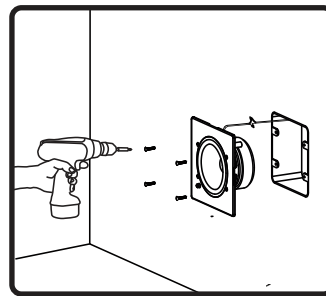

3. Install the CI-MM3-II into the installer supplied junction box using included fasteners.

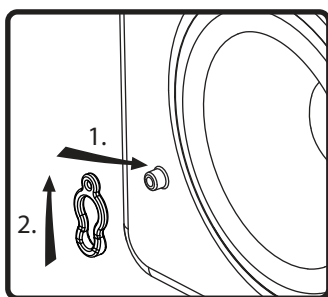

4. Attach grille safety clip by placing the large end of the clip over snap-fit post (1), then sliding clip until small end snaps into place around post (2).

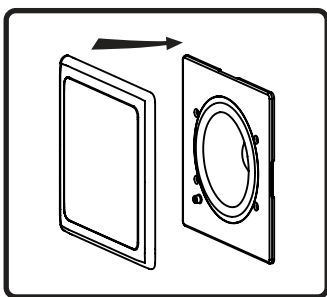

5. Align tabs on snap-fit grille with slots in baffle, gently press grille into place.

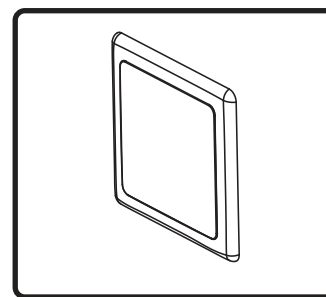

6. Done!