

ASSEMBLY INSTRUCTIONS

MODEL: IMP 26-181/182/183

Read this instruction carefully. Refer hardware and furniture part list for guidance. Be sure all parts are complete, before assembling. Place all wooden furniture part on a clean and flat soft surface to prevent scratches. Refer steps provided as assembling guide.

PART LIST (1 CHAIR)		
ITEM	DESCRIPTION	Q'TY
A	Chair Back	1 PC
B	Cushion Frame	1 PC
C	Leg Frame (M)	1 PC
D	Leg Frame (F)	1 PC
E	Footrest Ring	1 PC
TOOLS REQUIRED (NOT PROVIDED)		
PHILLIPS SCREWDRIVER		

HARDWARE LIST (1 CHAIR)		
ITEM	DESCRIPTION	Q'TY
a	JCBC Screw M6 x 40 mm 	14 PCS
b	JCBC Screw M6 x 50 mm 	4 PCS
c	JCBC Screw M6 x 80 mm 	4 PCS
d	Flat Washer 	22 PCS
e	Spring Washer 	22 PCS
f	Allen Key M4 	1 PC
g	Auto return Plate 	1 PC

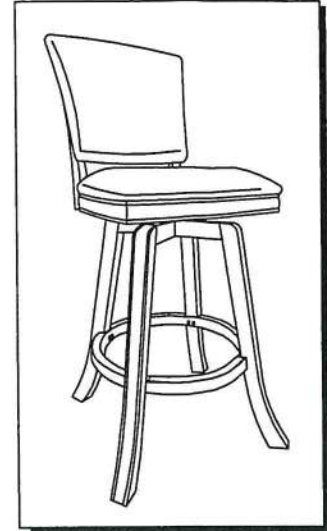

COMPLETE VIEW

STEP 1

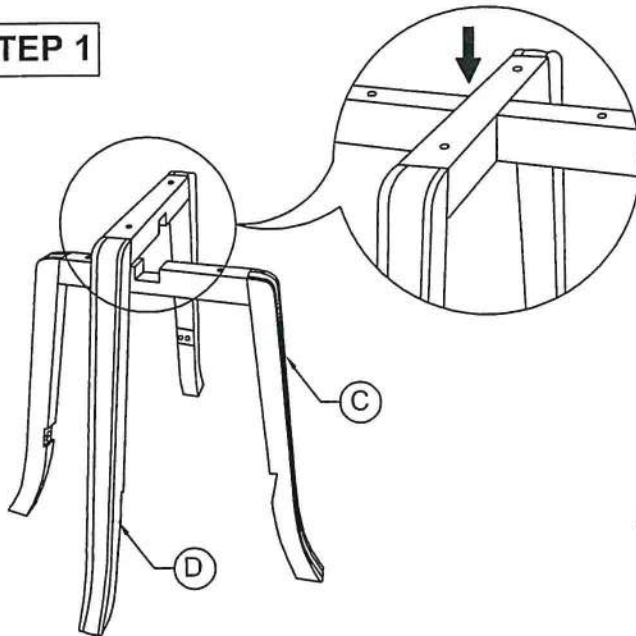

STEP 2

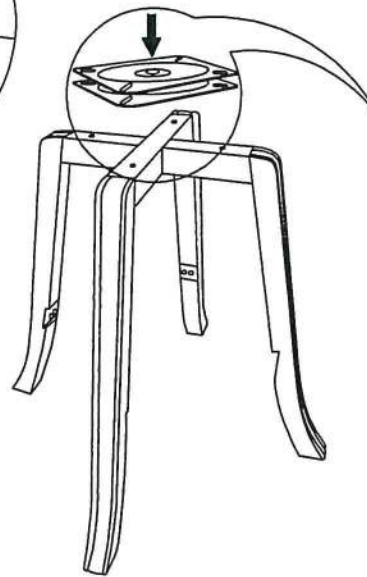

STEP 3

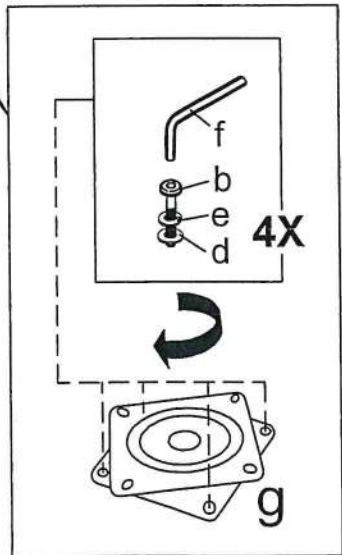
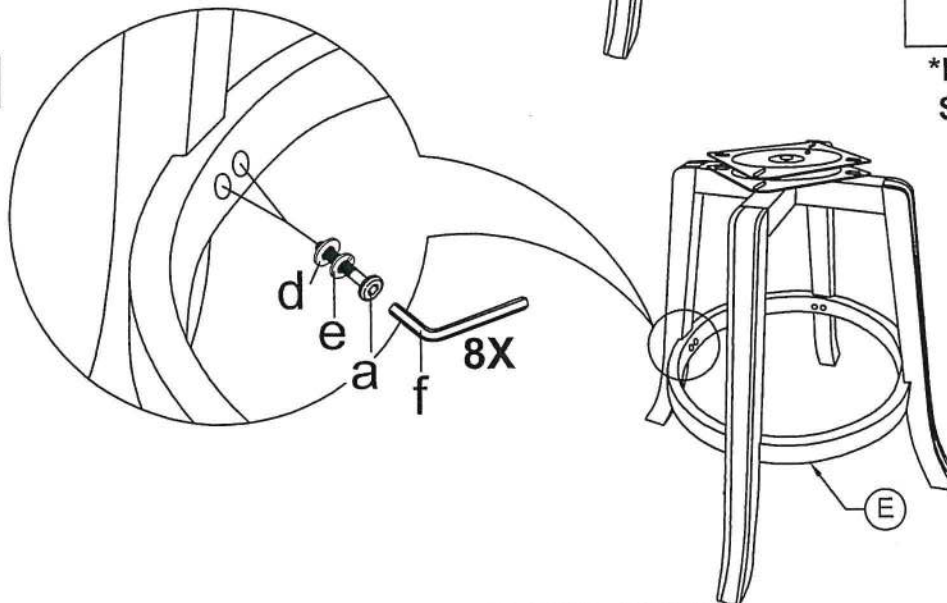

*PRESS AND TURN SWIVEL PLATE

NOTE: DO NOT TIGHTEN ANY BOLTS AT THIS TIME!

ASSEMBLY INSTRUCTIONS

MODEL: IMP 26-181/182/183

STEP 4

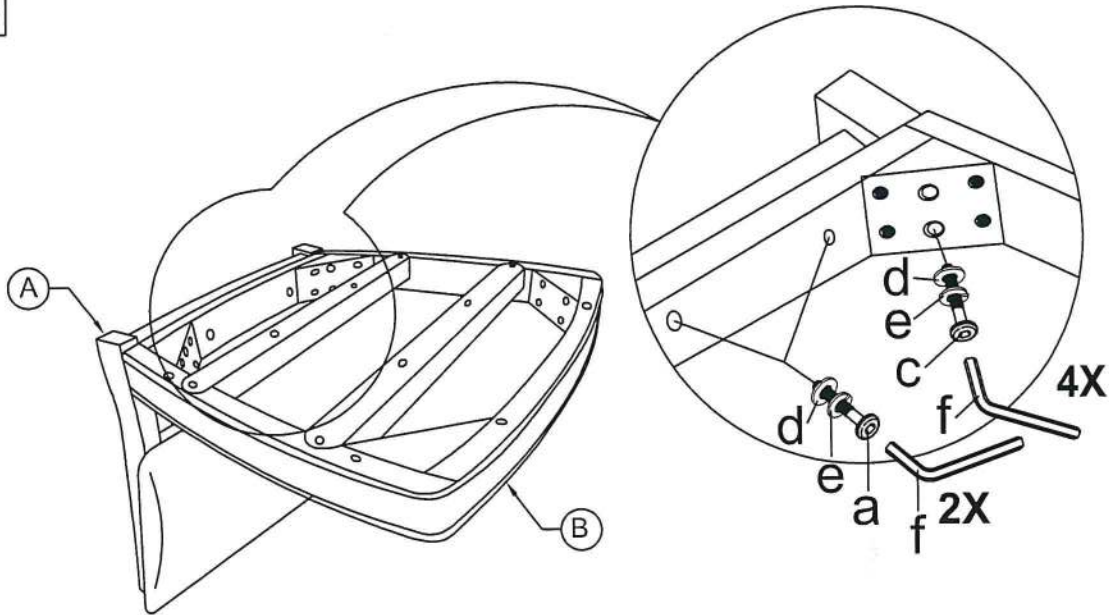

STEP 5

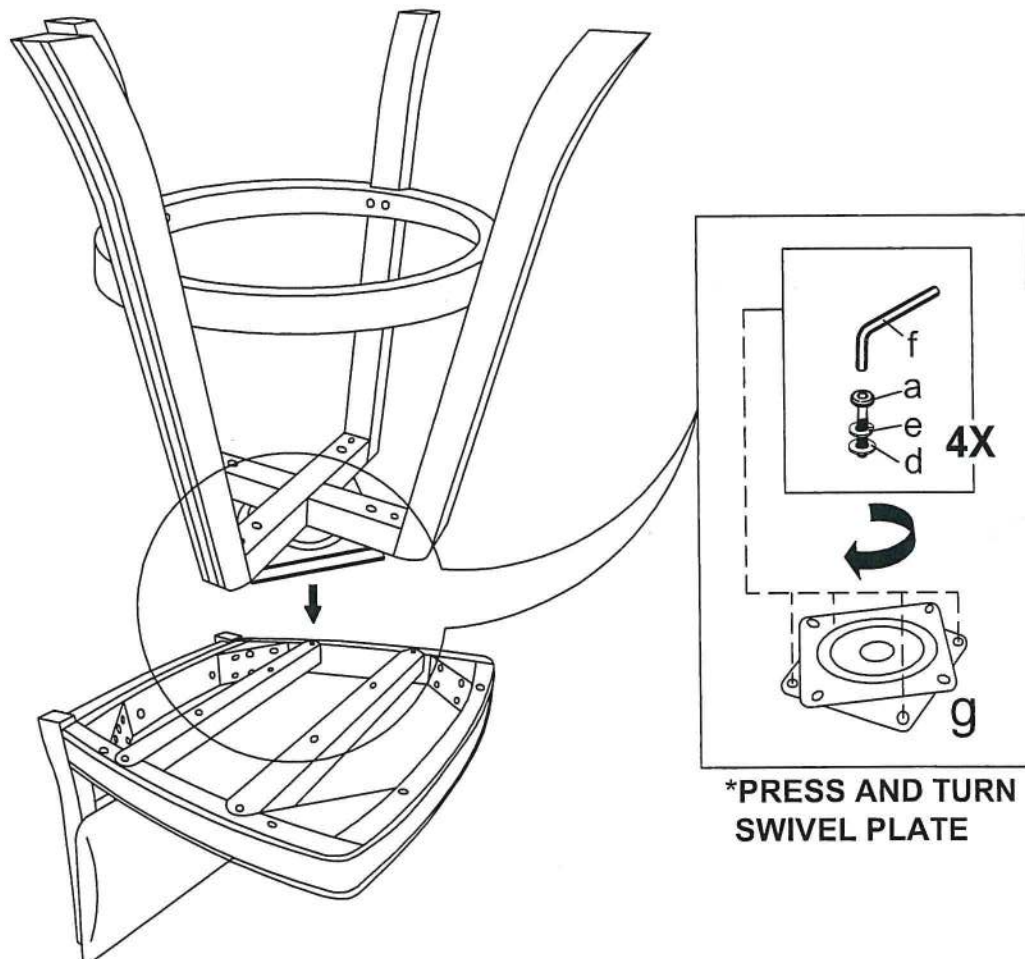

NOTE: To ensure that chair is level, place it upright on level surface and tighten all bolts.